

SINGLE PHASE CHARGER PERFORMANCES

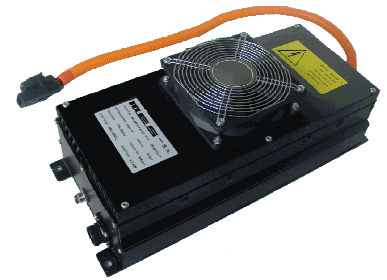

MECHANICAL AND ELECTRICAL CHARACTERISTICS	
BATTERY CHARGERS TYPE	BC240 – BC278 – BC336 – BC557
INPUT	
Voltage range	110-253V AC
Frequency	47-63Hz
RFI	EN 55014
Fusing	Bussmann type ABC-20 (UFG632320) 6.3x32 20A/250V (2x)
Input current	Limited TO 15.5A
SAFETY	
Module heatsink	Must be connected to safety ground
Applicable standard	EN 61851-1 / EN 61851-21
OUTPUT	
Power	3200 W Maximum, depending on input voltage
RFI	DC-FILTER
Fusing	Busmann FWC 20A-10F 10x38 20A 600V (2X)
CONTROL INTERFACE	
PWM Power control signal	Active high control signal with Pulse Width modulation
PWM signal frequency	0,3 ÷ 1kHz
PWM signal voltage range (high-level)	8-30 Vpp
PWM signal modulation (See manual for detailed relation between PWM value and Out power)	0% PWM AND 100% Power OFF
	<10% PWM Power MIN 32W
	95% PWM Power MAX, 3200W at 230V input
Over-temperature	INTERNAL SHUT DOWN
Evacuated air flow	> 90 m³/h @ 0 Pa
GENERAL SPECIFICATIONS	
Temperature at heatsink	-10.....+65°C
Cooling	Fan, mounted on the heat sink
Ambient temperature	+40°C MAX
Thermal shutdown	Active when the internal temperature exceeding the maximum value
Efficiency	>94% @ full load
INSULATION TEST ON 100% OF UNITS	
Input to earth	1500 VAC max limit 45mA
Output to earth	1750 VAC max limit 45mA
Output to interface	1750 VAC max limit 45mA
Input to output	1750 VAC max limit 45mA

Available types

The following summary lists the types available with their ordering designations:

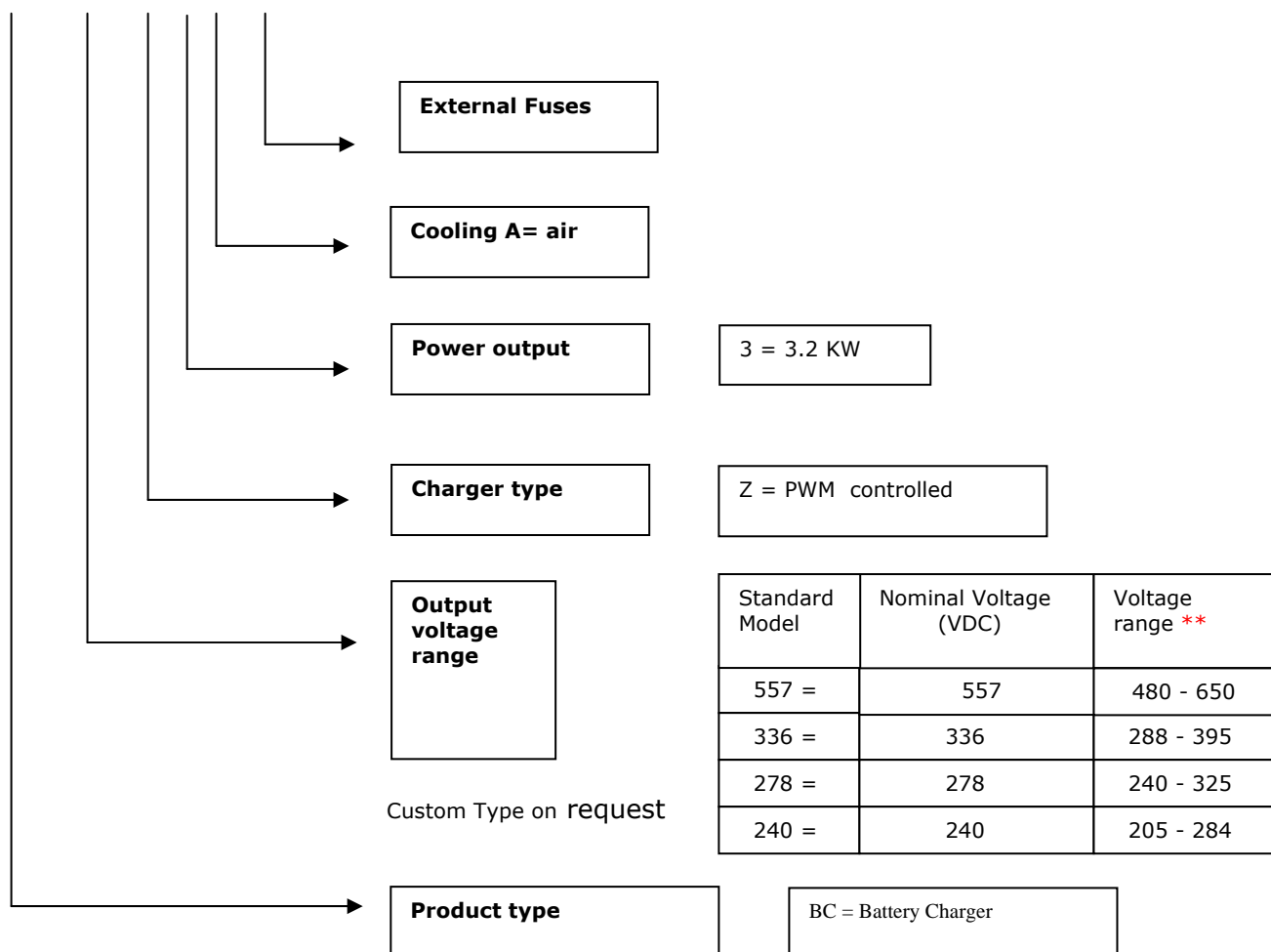
BC-278-Z-3-A-EF**** Important:**

by "Voltage range", we mean the approximate nominal operative range, with the purpose of selecting the type of charger which is most suitable for the intended use. Each charger is provided with a protection circuit inside, so as to prevent damages when disconnecting from the battery.

Such voltage value is fixed and is not in any case to be intended as a protection system for the battery in case of failure.

Please be so kind to contact MES sa as for the details connected to such parameters.

MECHANICAL DESIGN	
Size (w x h x d mm)	169 x 136 x 355
Weight	7 Kg
Input connectors	AMPHENOL 5440 MDA203F 3X25A
Output connectors	FCI DCSHHPE02BKSV
Protection class	IP55

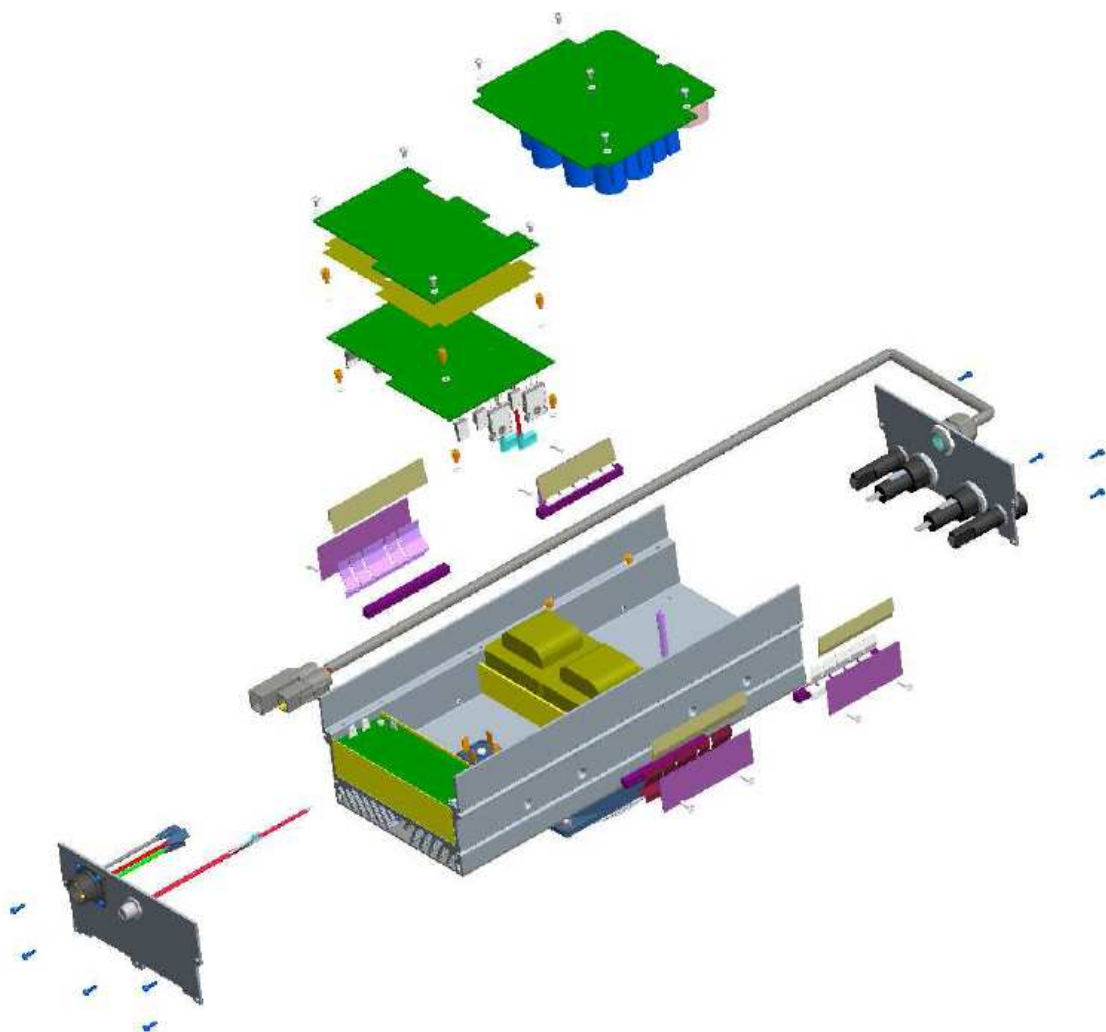

CONNETTORE 4 POLI MASCHIO EM12M4FIX AU (HIRSCHMANN)
4 PIN CONNECTOR ELST 412 M16

CONNETTORE 3 POLI 25A MASCHIO a pannello AIR LB (AMPHENOL)
3 PIN CONNECTOR 25A

Portafusibile 10x38 30A 600V (pcs.2)
Fuse Holder 10x38 30A 600V (pcs.2)

PORTAFUSIBILE 6.3x32 16A IP68 (pcs.2)
Fuse Holder 6.3x32 16A IP68 (pcs.2)

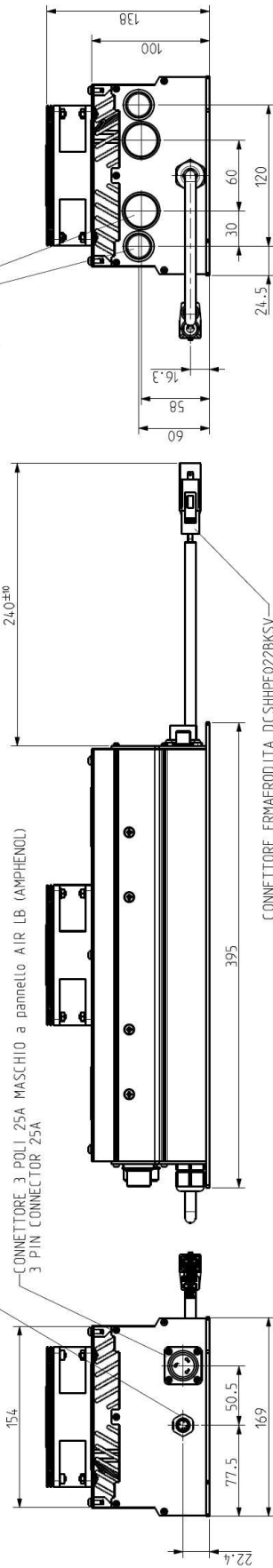

CONNETTORE ERMAFRODITA DC5HP022BKSV
ERMAPHRODITE CONNECTOR

ETICHETTA DI PERICOLO "PARTI IN TENSIONE"
WARNING ADESIV LABEL

ETICHETTA DI IDENTIFICAZIONE
IDENTIFICATION ADESIV LABEL

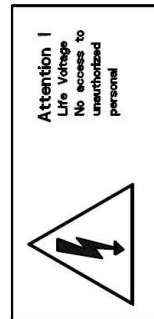
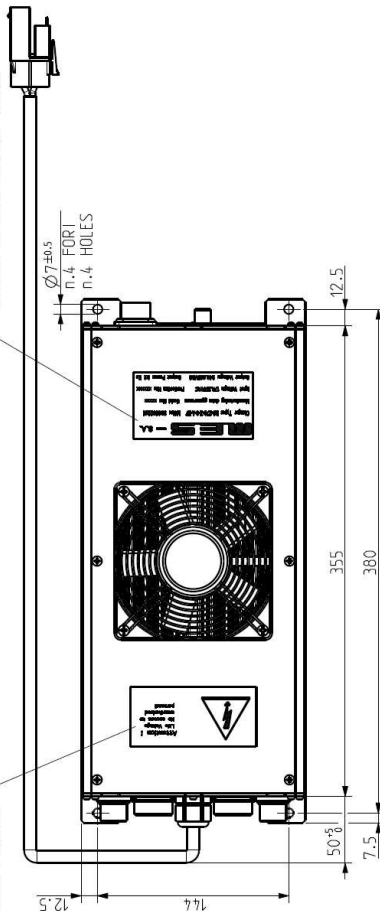

ETICHETTA DI PERICOLO "PARTI IN TENSIONE"
WARNING ADESIV LABEL
SCALA 1:1

ETICHETTA DI IDENTIFICAZIONE
IDENTIFICATION ADESIV LABEL
SCALA 1:1

NOTE:
TOLLERANZE GENERALI ±1.5
GENERAL TOLERANCES ±1.5

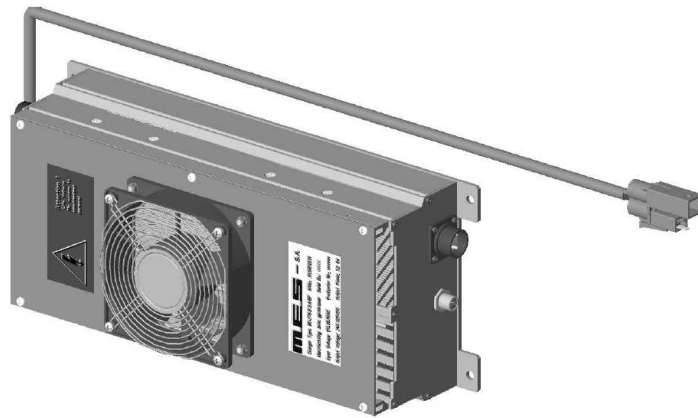

Modifiche/Modification record

- 00 - Riferimento campionario P1085 - Ossola
- 01 - Riferimento campionario P1095A - ZV/O1/11 Ossola

Disegnato/Drawn Ossola	Verificato/Checked Ossola	Disegnato/Drawn ASSIEME CHARGER BC 278 portafusibili esterno	Verificato/Checked ZS
Data/Date 26/10/10	Scala/Scale 2:5	Tratto da/From ---	Tratto da/From ---
Caricabatterie AC/DC UNIVERSAL			
Caricabatterie CARICABATTERIE connessione posteriore COMPONENTISTICA			
Modifica/Modification 30-99022			
Scale 1:1			
01			